

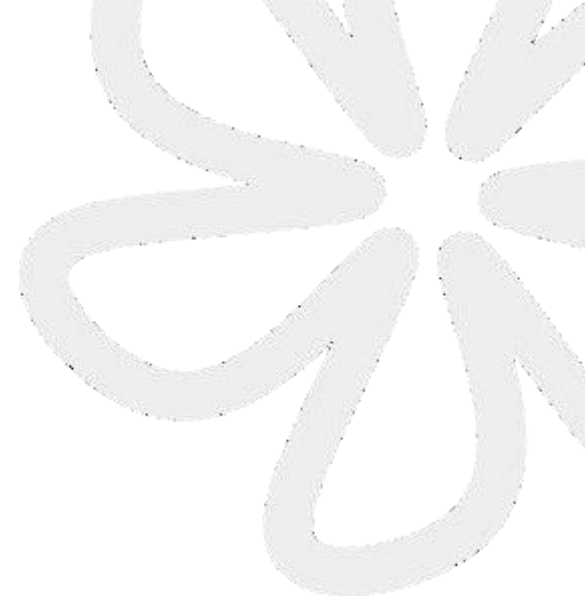

Jiangsu Flower Intelligent Technology Co., Ltd.



ABOUT US

Our company is a comprehensive intelligent manufacturing enterprise specializing in mobile/capsule housing, integrated health, cultural tourism, and related sectors., supported by a team of experienced technical professionals and a strong domestic and international sales network.

With advanced production facilities and well-established manufacturing processes, FlowerIntelligent integrates high-end technologies and standardized management systems to deliver reliable and forward-looking solutions. The company is committed to meeting diverse application needs across residential and health-related sectors in both domestic and global markets.





MODULAR DESIGN · FLEXIBLE SPACE SOLUTIONS



Flexible Applications

Suitable for a wide range of applications such as residential housing, resort cabins, commercial spaces, and temporary facilities.

Built with durable materials and weather-resistant finishes, suitable for long-term outdoor environments.



Customizable Options

Layouts, configurations, and interior options can be customized according to specific project requirements.

An aerial view of a tropical beach with several modern, white modular houses built on stilts. The houses have large glass windows and balconies. In the foreground, there is a wooden deck with lounge chairs and a large umbrella. A few people are walking on the sandy beach. In the background, there is a dense line of palm trees and a wooden walkway on a raised platform.

Table Of Contents

Modular House

- Space capsule house
- Apple Cabin House
- Garbage Room

Project Cases

- Our Proven Projects



Flower House

Space Capsule House

More than a building product, the Space Capsule House represents an efficient and replicable spatial solution, offering greater flexibility and control for project development.

F3 Space Capsule House

GROUND FLOOR (L × W × H)	11,500 × 3,300 × 3,200 mm
UPPER FLOOR (L × W × H)	8,500 × 3,300 × 3,200 mm
LAND OCCUPATION AREA	50 m ²
NUMBER OF GUESTS	3 – 4 persons
CABIN WEIGHT	9,000 kg

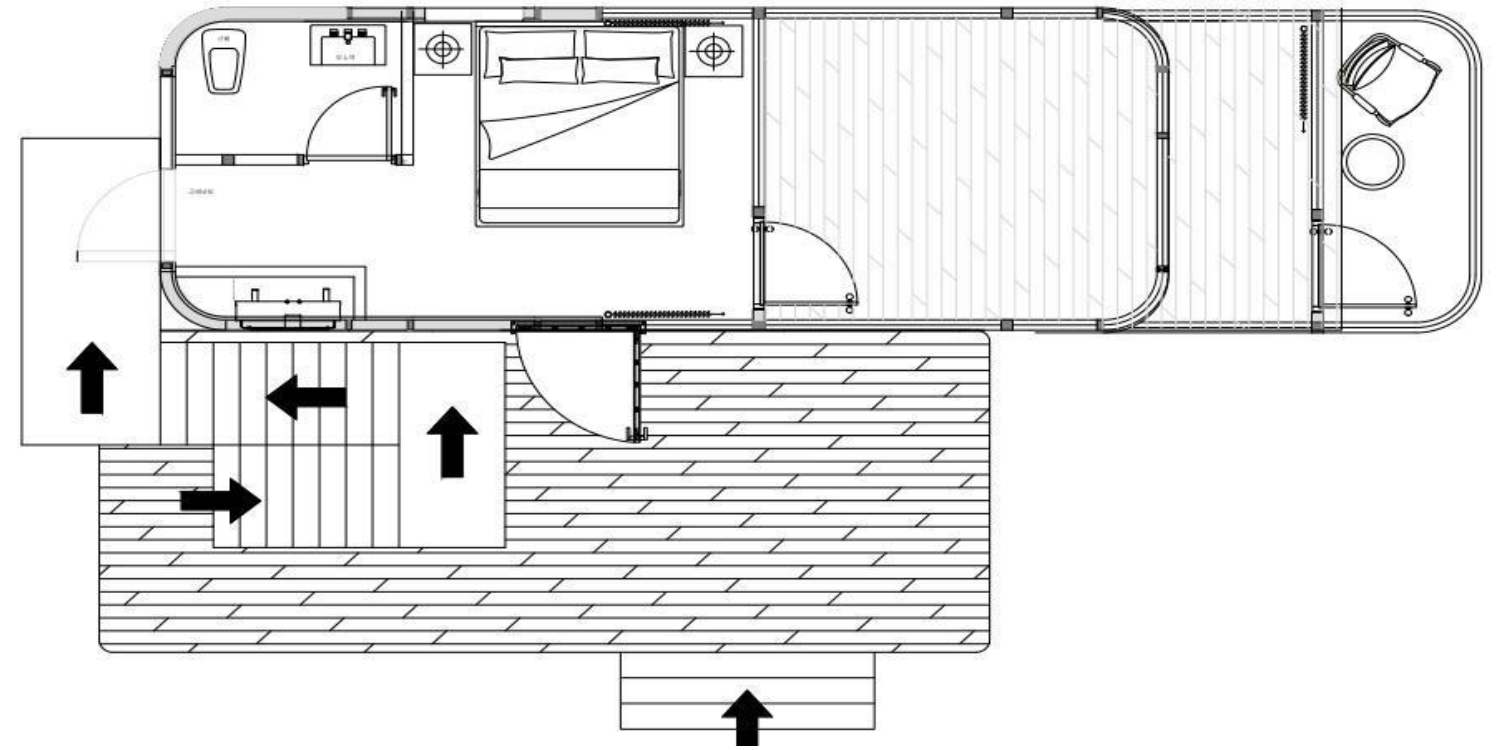
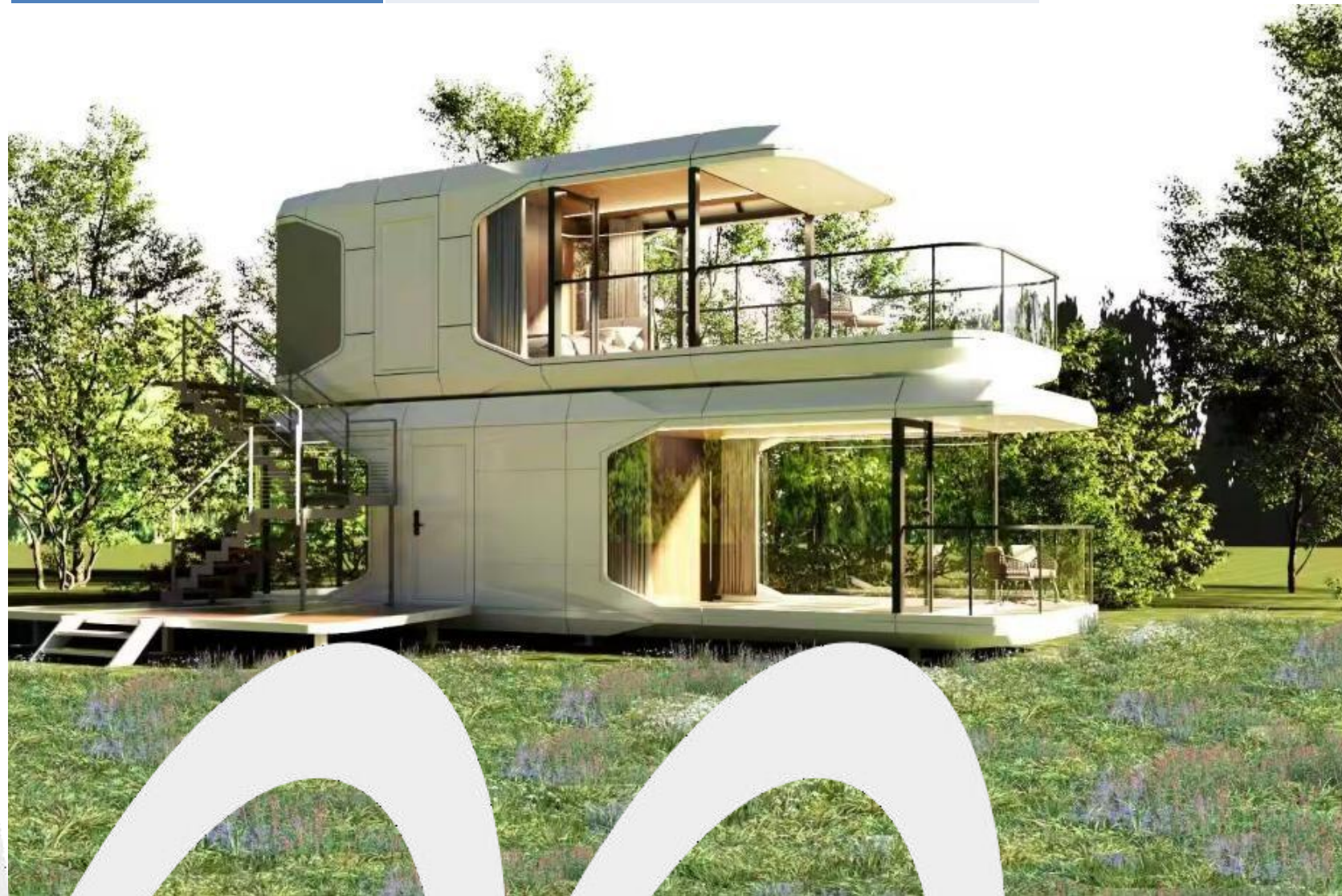

1st Floor

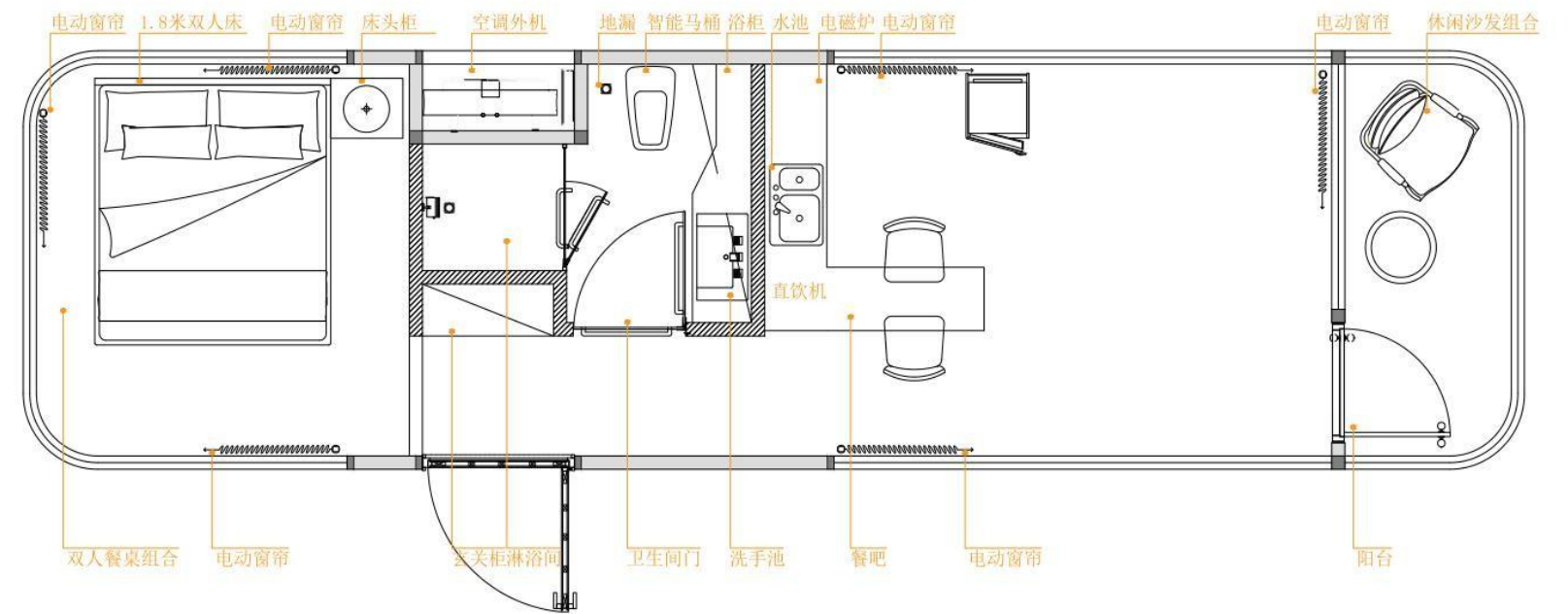

2nd Floor

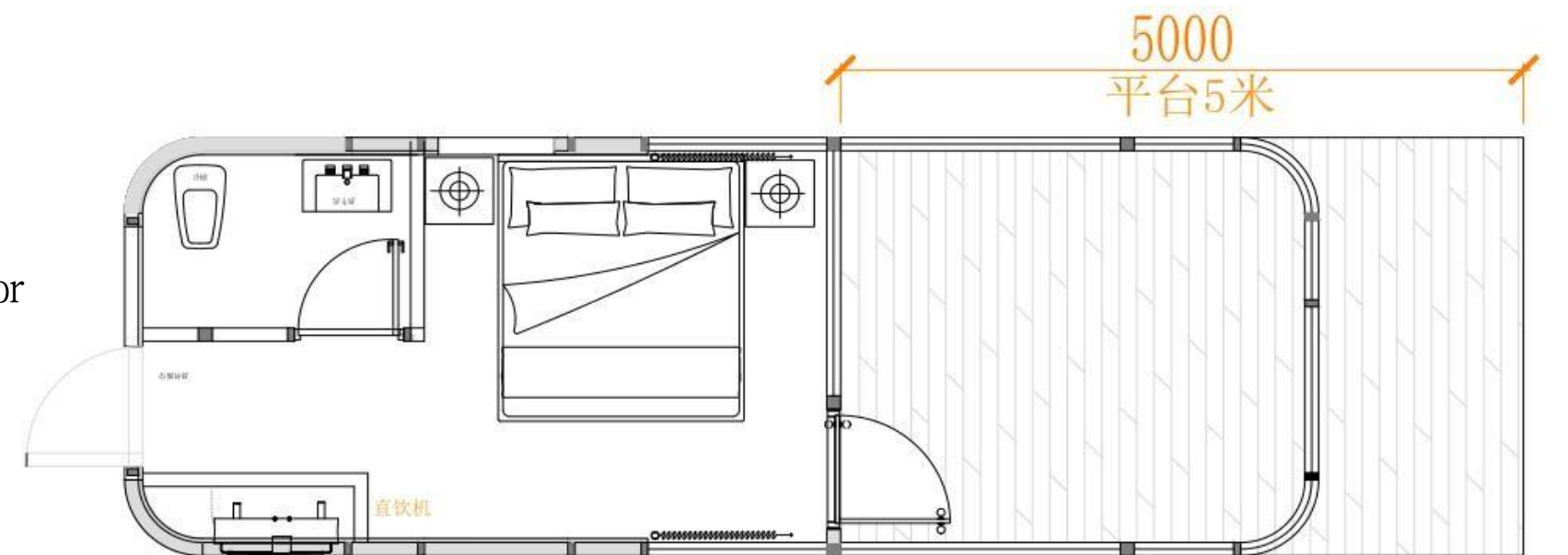

What You See Is What You Get



EXTERNAL MAINTENANCE SYSTEM

Galvanized steel frame system provides strong structural support and durability. Fluorocarbon sprayed aluminum alloy shell module offers excellent corrosion resistance, weather protection, and a premium finish. Insulation, waterproof and moisture-proof structural system ensures thermal efficiency. Central tempered glass doors and windows with laminated tempered glass skylight. Stainless steel entrance door for security. Panoramic balcony extends living space outdoors.

INTERIOR DECORATION

Standard color integrated ceiling and wall modules for a clean, uniform appearance. Environmentally friendly wooden floor throughout the living space. Bathroom features privacy glass door, marble and ceramic tile floor, customized sink, countertop, mirror, toilet, faucet, and shower. Bar area included for added functionality. Whole house lighting system and complete water/electricity system. 2P Midea variable frequency heating and cooling air conditioner delivers energy-efficient climate comfort. Water heater supplies consistent hot water.

CUSTOMER CONTROL SYSTEM

Card insertion and removal panel automatically activates power when a card is inserted and cuts power when removed. Multi-scenario mode function panel allows users to switch between different lighting presets such as reading, relaxing, or entertainment. Intelligent integrated control manages both lighting and curtains together for seamless convenience. Whole house smart voice control enables hands-free operation of multiple systems. Mobile phone smart access control provides keyless, remote entry for enhanced security and ease of use.



F5 Space Capsule House

DIMENSIONS (L × W × H)	8,500 × 3,300 × 3,200 mm
LAND OCCUPATION AREA	28 m ²
NUMBER OF GUESTS	2 persons
CABIN WEIGHT	6,000 kg

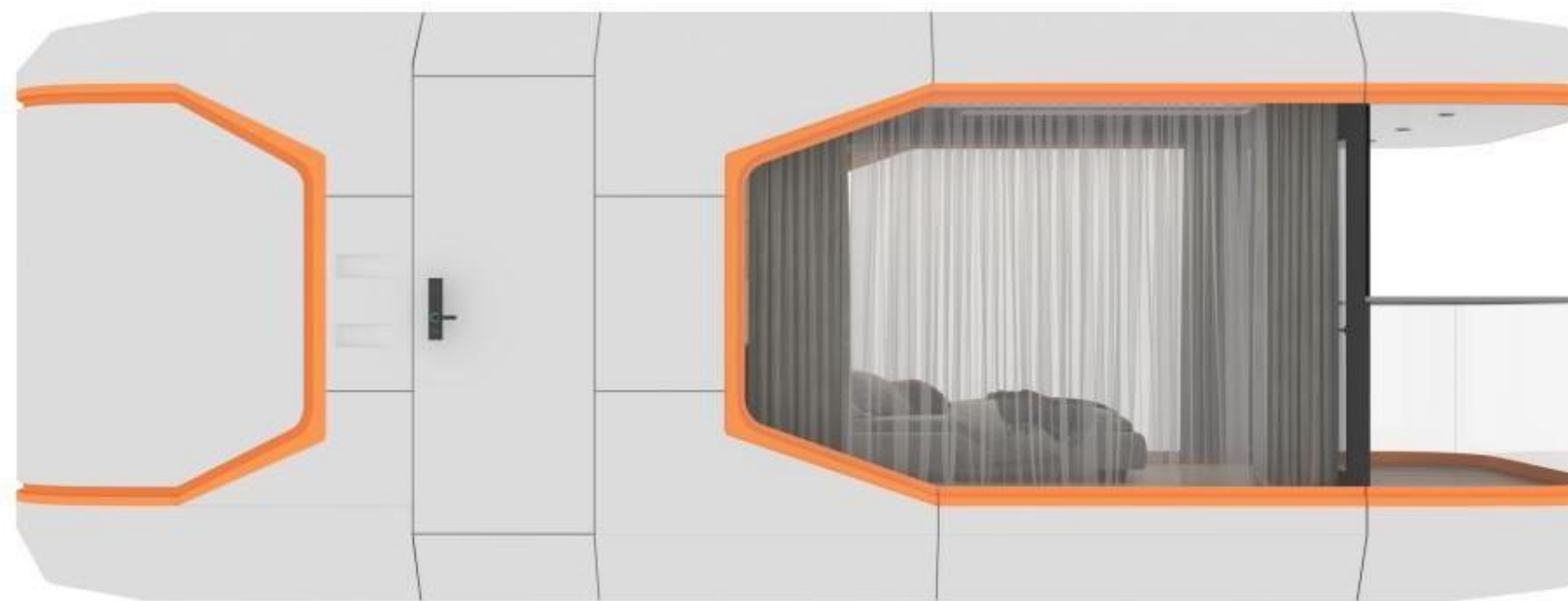
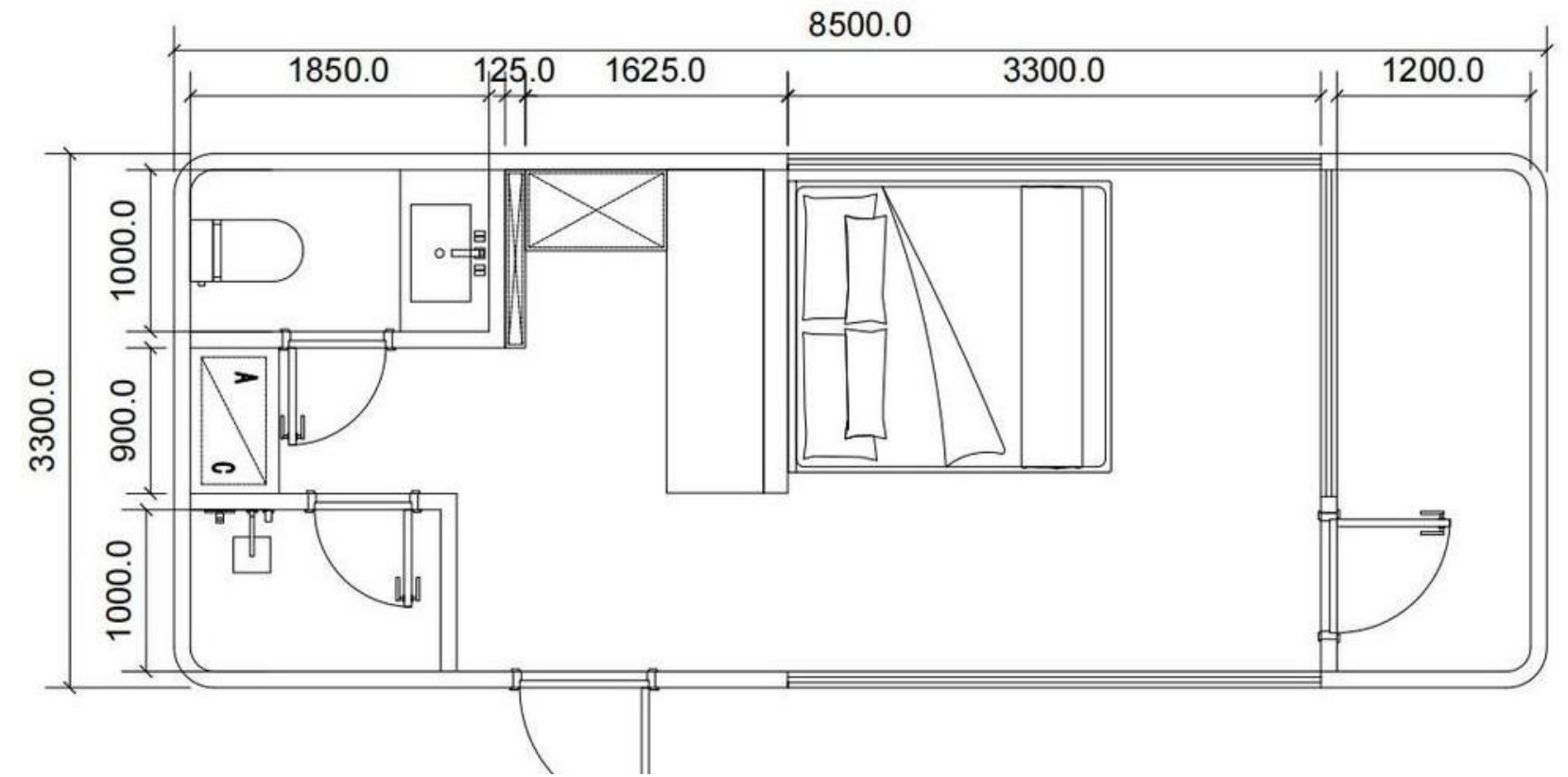

What You See Is What You Get



EXTERNAL MAINTENANCE SYSTEM

Galvanized steel frame system provides strong structural support and long-lasting durability. Fluorocarbon sprayed aluminum alloy shell module offers excellent corrosion resistance, weather protection, and a premium aesthetic finish. Insulation, waterproof and moisture-proof structural system ensures thermal efficiency and environmental protection. Central tempered glass doors and windows with central laminated tempered glass skylight deliver safety and natural light. Stainless steel entrance door provides security and a modern appearance. Panoramic balcony extends living space outdoors with an open view.

INTERIOR DECORATION SYSTEM

Standard color integrated ceiling and wall modules deliver a clean, uniform appearance throughout. Environmentally friendly wooden floor provides sustainable, comfortable flooring. Bathroom features privacy glass door, marble and ceramic tile floor, customized sink, countertop, mirror, toilet, faucet, and shower. Bar area adds functional space. Whole house lighting system and complete water and electricity system ensure full utility coverage. 2P Midea variable frequency heating and cooling air conditioner offers energy-efficient climate control. Water heater supplies consistent hot water for daily needs.

CUSTOMER CONTROL SYSTEM

Card insertion and removal panel automatically activates power when a card is inserted and cuts power when removed. Multi-scenario mode function panel allows users to switch between different lighting presets for various activities. Intelligent integrated control manages both lighting and curtains together for seamless operation. Whole house smart voice control enables hands-free management of multiple systems. Mobile phone smart access control provides keyless, remote entry for enhanced security and convenience.



F7 Space Capsule House

DIMENSIONS (L x W x H)	11,500 x 3,300 x 3,200 mm
LAND OCCUPATION AREA	38 m²
NUMBER OF GUESTS	2 – 4 persons
CABIN WEIGHT	7,000 kg

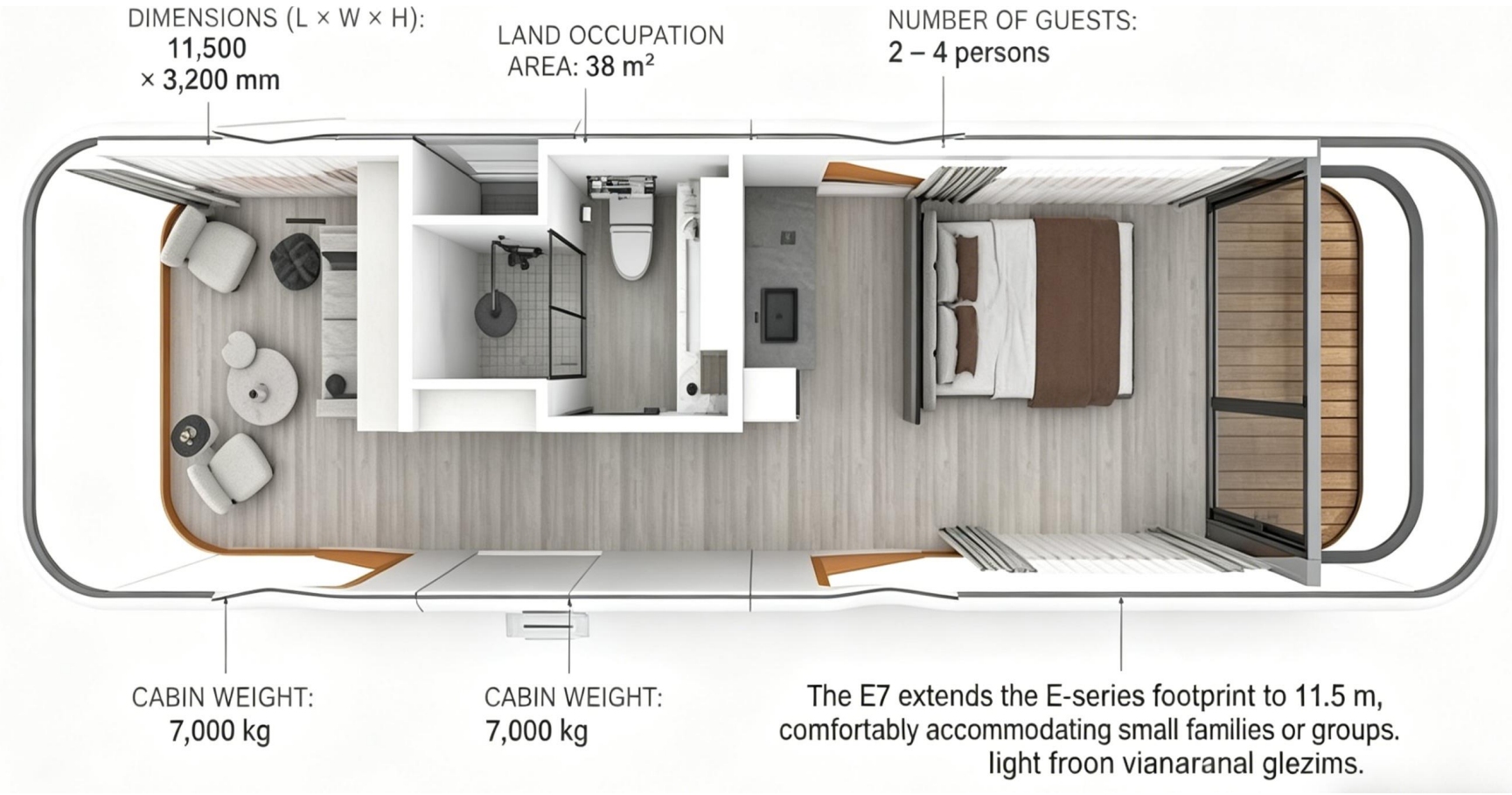
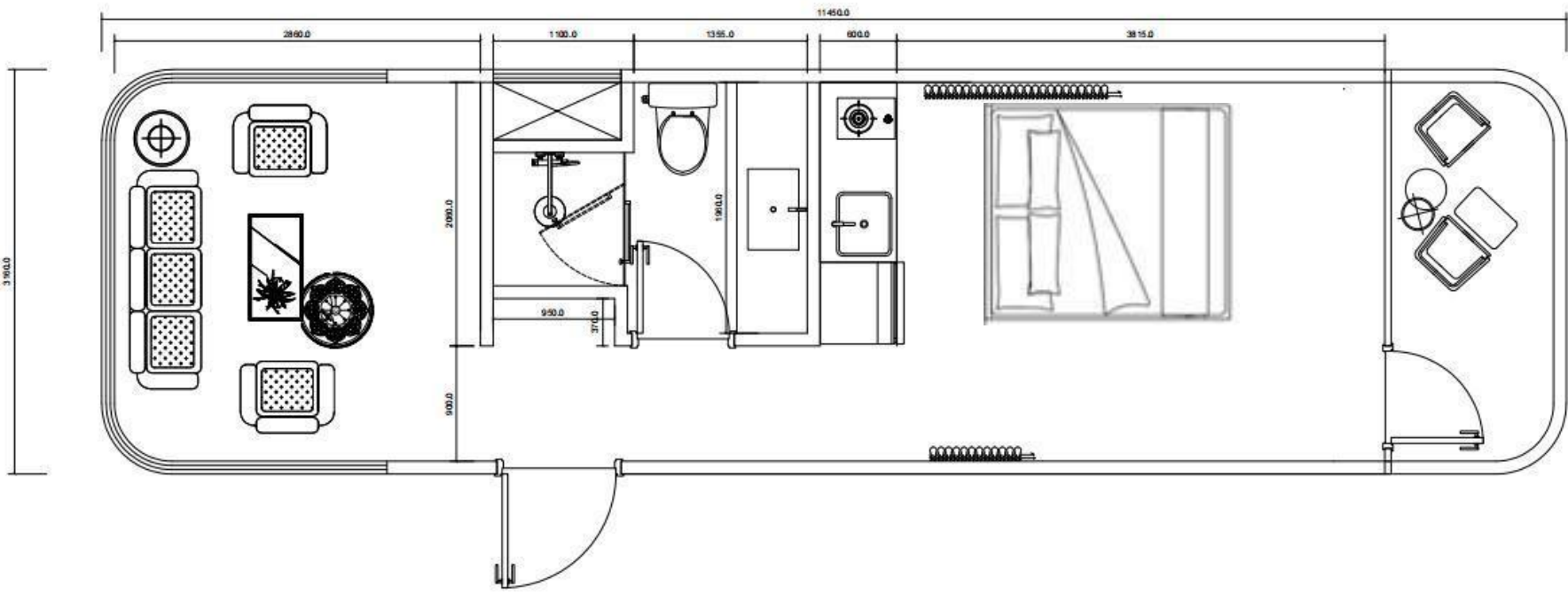

What You See Is What You Get



EXTERNAL MAINTENANCE SYSTEM

Galvanized steel frame system provides strong structural support and long-lasting durability. Fluorocarbon sprayed aluminum alloy shell module offers excellent corrosion resistance, weather protection, and a premium aesthetic finish. Insulation, waterproof and moisture-proof structural system ensures thermal efficiency and environmental protection. Central tempered glass doors and windows with central laminated tempered glass skylight deliver safety and natural light. Stainless steel entrance door provides security and a modern appearance. Panoramic balcony extends living space outdoors with an open view.

INTERIOR DECORATION

Standard color integrated ceiling and wall modules deliver a clean, uniform appearance throughout. Environmentally friendly wooden floor provides sustainable, comfortable flooring. Bathroom features privacy glass door, marble and ceramic tile floor, customized sink, countertop, mirror, toilet, faucet, and shower. Bar area adds functional space. Whole house lighting system and complete water and electricity system ensure full utility coverage. 2P Midea variable frequency heating and cooling air conditioner offers energy-efficient climate control. Water heater supplies consistent hot water for daily needs.

CUSTOMER CONTROL SYSTEM

Card insertion and removal panel automatically activates power when a card is inserted and cuts power when removed. Multi-scenario mode function panel allows users to switch between different lighting presets for various activities. Intelligent integrated control manages both lighting and curtains together for seamless operation. Whole house smart voice control enables hands-free management of multiple systems. Mobile phone smart access control provides keyless, remote entry for enhanced security and convenience.



F7 Space Capsule House

DIMENSIONS (L × W × H)	11,500 × 3,300 × 3,200 mm
LAND OCCUPATION AREA	38 m ²
NUMBER OF GUESTS	2 – 4 persons
CABIN WEIGHT	7,000 kg

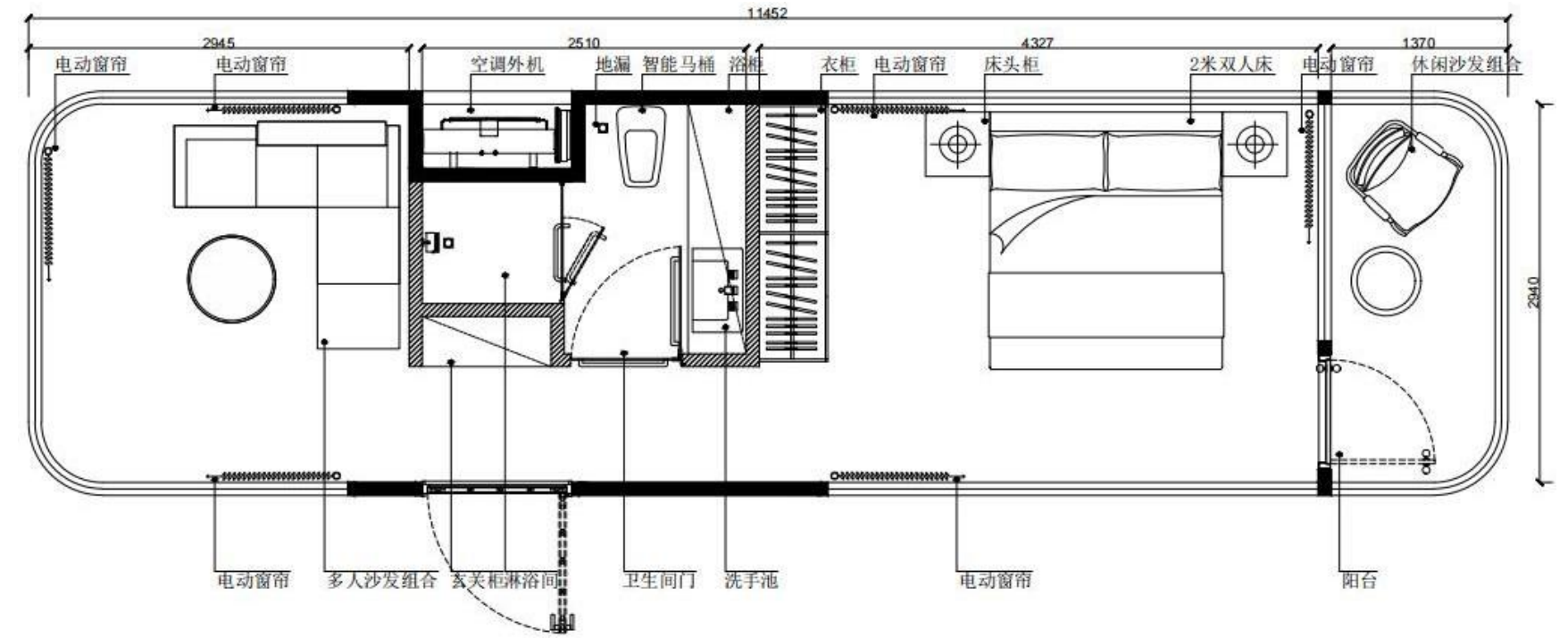

What You See Is What You Get



EXTERNAL MAINTENANCE SYSTEM

Galvanized steel frame system provides strong structural support and long-lasting durability. Fluorocarbon sprayed aluminum alloy shell module offers excellent corrosion resistance, weather protection, and a premium aesthetic finish. Insulation, waterproof and moisture-proof structural system ensures thermal efficiency and environmental protection. Central tempered glass doors and windows with central laminated tempered glass skylight deliver safety and natural light. Stainless steel entrance door provides security and a modern appearance. Panoramic balcony extends living space outdoors with an open view.

INTERIOR DECORATION

Standard color integrated ceiling and wall modules deliver a clean, uniform appearance throughout. Environmentally friendly wooden floor provides sustainable, comfortable flooring. Bathroom features privacy glass door, marble and ceramic tile floor, customized sink, countertop, mirror, toilet, faucet, and shower. Bar area adds functional space. Whole house lighting system and complete water and electricity system ensure full utility coverage. 2P Midea variable frequency heating and cooling air conditioner offers energy-efficient climate control. Water heater supplies consistent hot water for daily needs.

CUSTOMER CONTROL SYSTEM

Card insertion and removal panel automatically activates power when a card is inserted and cuts power when removed. Multi-scenario mode function panel allows users to switch between different lighting presets for various activities. Intelligent integrated control manages both lighting and curtains together for seamless operation. Whole house smart voice control enables hands-free management of multiple systems. Mobile phone smart access control provides keyless, remote entry for enhanced security and convenience.



Double Layer Space Capsule House

MODULE DIMENSIONS (PER UNIT)	11,500 × 3,200 × 3,200 mm
CONFIGURATION	3 × 3 modular array (two storeys)
NUMBER OF GUESTS	4 persons
CABIN WEIGHT	7,000 kg

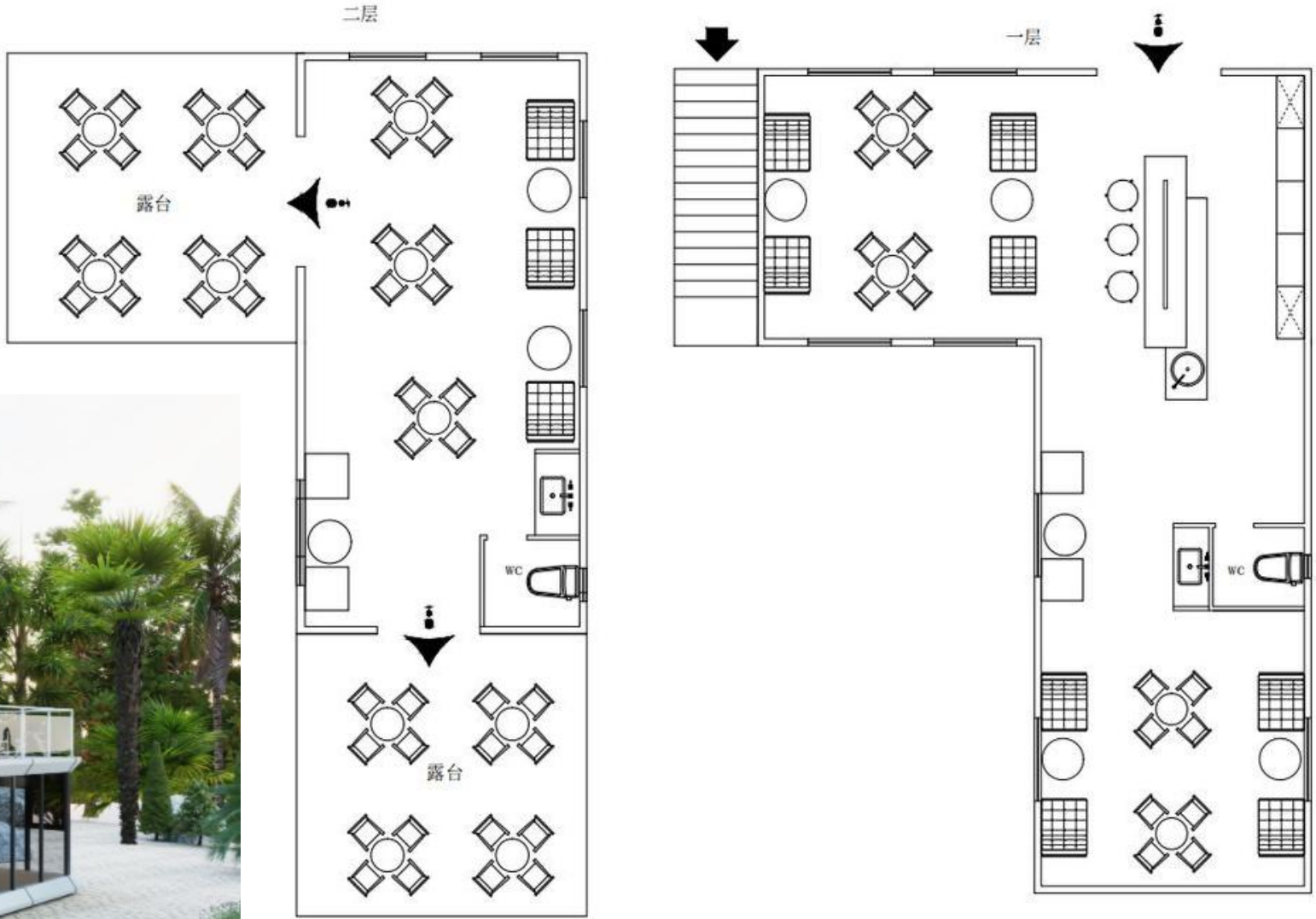

What You See Is What You Get



EXTERNAL MAINTENANCE SYSTEM

Galvanized steel frame system provides strong structural support and long-lasting durability. Fluorocarbon sprayed aluminum alloy shell module offers excellent corrosion resistance, weather protection, and a premium aesthetic finish. Insulation, waterproof and moisture-proof structural system ensures thermal efficiency and environmental protection. Central tempered glass doors and windows with central laminated tempered glass skylight deliver safety and natural light. Stainless steel entrance door provides security and a modern appearance. Panoramic balcony extends living space outdoors with an open view.

INTERIOR DECORATION

Standard color integrated ceiling and wall modules deliver a clean, uniform appearance throughout. Environmentally friendly wooden floor provides sustainable, comfortable flooring. Bathroom features privacy glass door, marble and ceramic tile floor, customized sink, countertop, mirror, toilet, faucet, and shower. Bar area adds functional space. Whole house lighting system and complete water and electricity system ensure full utility coverage. 2P Midea variable frequency heating and cooling air conditioner offers energy-efficient climate control. Water heater supplies consistent hot water for daily needs.

CUSTOMER CONTROL SYSTEM

Card insertion and removal panel automatically activates power when a card is inserted and cuts power when removed. Multi-scenario mode function panel allows users to switch between different lighting presets for various activities. Intelligent integrated control manages both lighting and curtains together for seamless operation. Whole house smart voice control enables hands-free management of multiple systems. Mobile phone smart access control provides keyless, remote entry for enhanced security and convenience.





Flower Intelligent

Apple Cabin House

The Apple Cabin House is a fully finished modular mobile building solution that combines modern design with functional efficiency.

N7 Apple Cabin House



DIMENSIONS (L x W x H)	11,500 x 3,300 x 3,200 mm
LAND OCCUPATION AREA	38 m ²
NUMBER OF GUESTS	2 – 4 persons
CABIN WEIGHT	7,000 kg

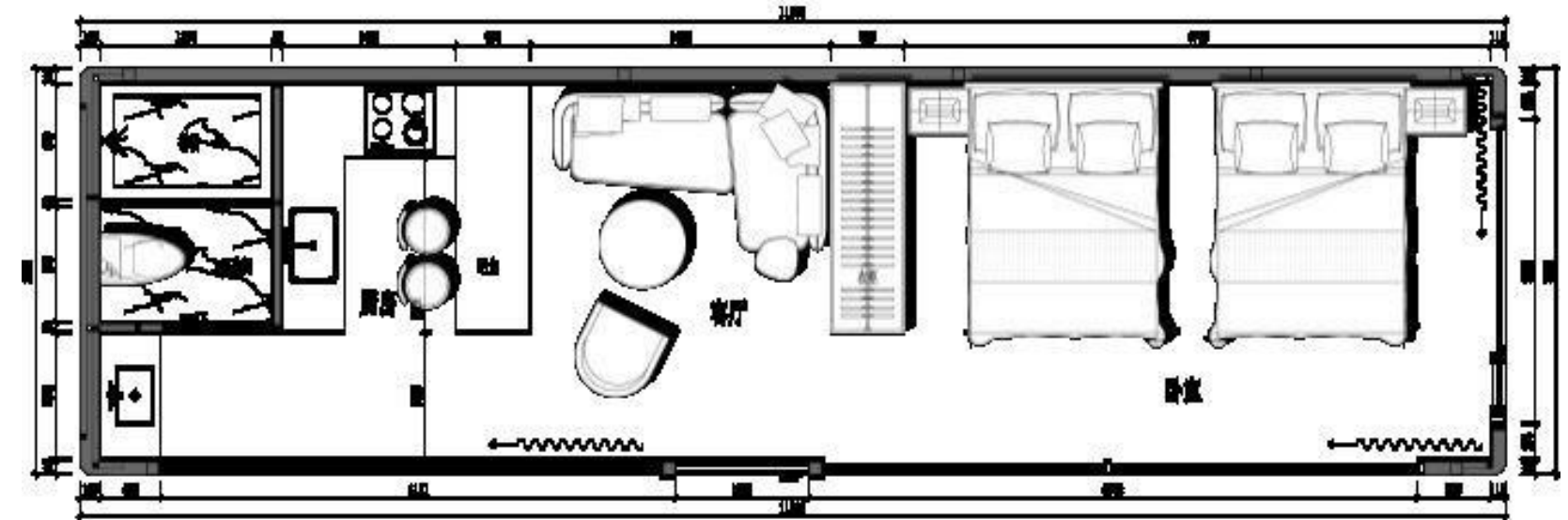

The Apple Cabin House features a galvanized steel frame and fluorocarbon sprayed aluminum shell with insulation and waterproofing. Central tempered glass doors, windows, and skylight, plus a stainless-steel entrance door and panoramic balcony. Interior includes standard color integrated ceiling and wall modules, eco-friendly wood flooring, a full bathroom with custom fixtures, bar, lighting, plumbing, electrical systems, a 2P Midea air conditioner, and water heater. Smart controls include card-activated power, multi-scenario lighting, integrated lighting and curtain control, voice control, and mobile phone access. The cabin can be customized for layout, exterior, and interior based on project needs.

H7 Apple Cabin House



DIMENSIONS (L × W × H)	11,500 × 3,300 × 3,200 mm
LAND OCCUPATION AREA	38 m ²
NUMBER OF GUESTS	2 – 4 persons
CABIN WEIGHT	7,500 kg

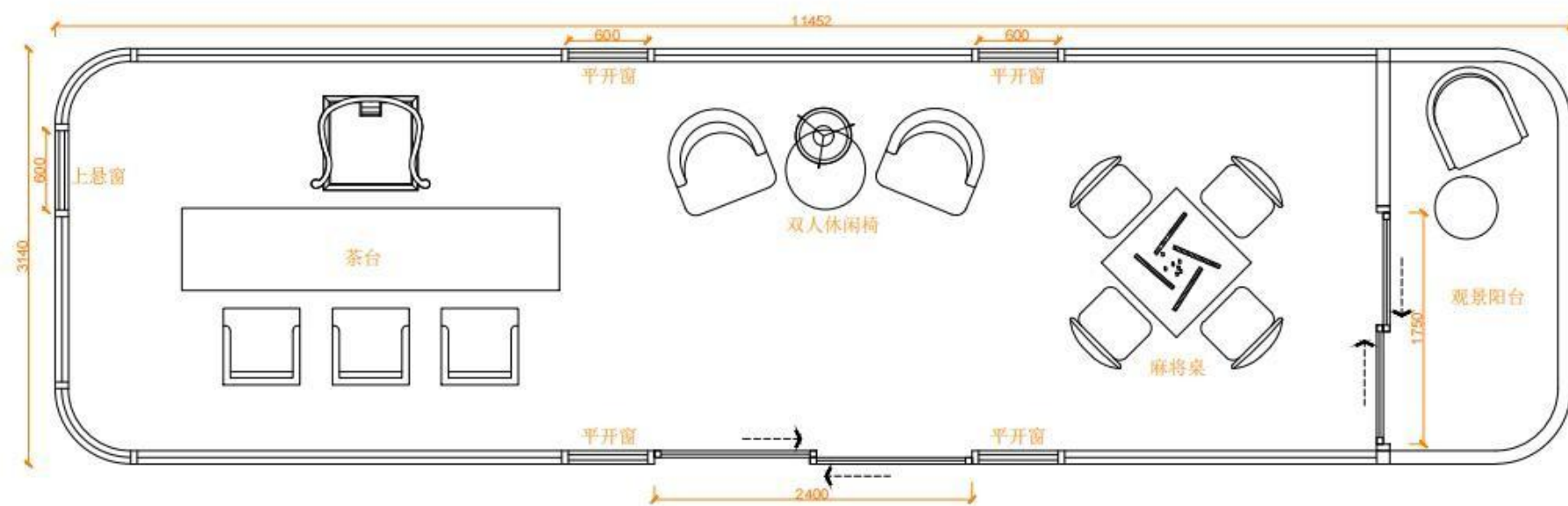

Customized Shark Capsule

DIMENSIONS (L x W x H)	11,500 x 3,300 x 3,200 mm
LAND OCCUPATION AREA	32 m ²
NUMBER OF GUESTS	2 persons
CABIN WEIGHT	7,000 kg

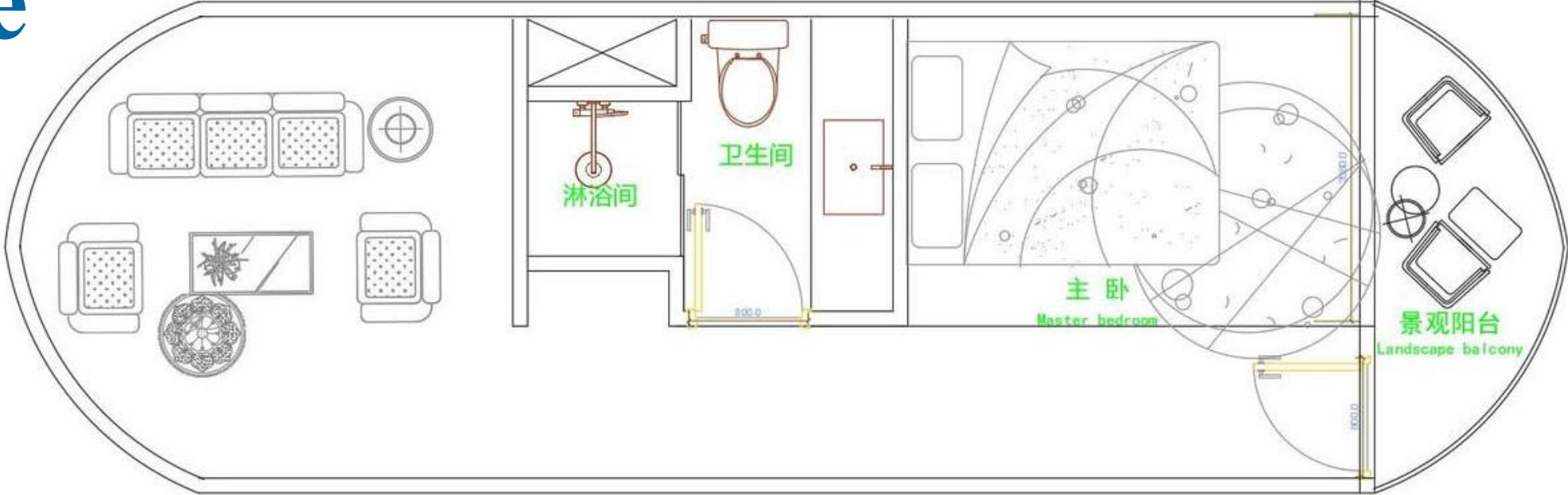

Customized Apple Cabin Tea Room

DIMENSIONS (L × W × H)	9,600 × 3,300 × 3,200 mm
LAND OCCUPATION AREA	32 m ²
CAPACITY	2 – 8 persons
CABIN WEIGHT	7,000 kg

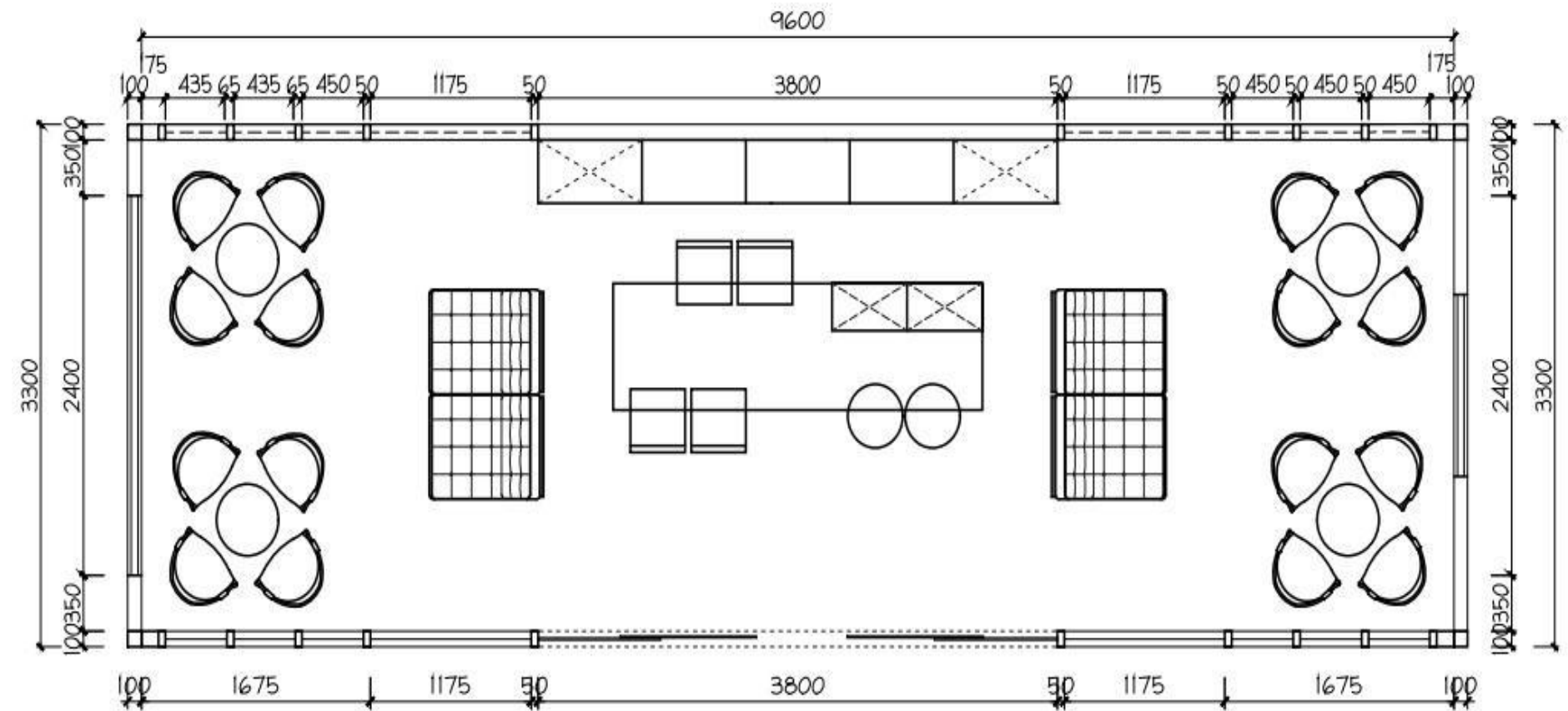

H3 Sauna room



DIMENSIONS (L x W x H)	5,800 x 3,300 x 3,200 mm
LAND OCCUPATION AREA	20 m ²
NUMBER OF GUESTS	2 persons
CABIN WEIGHT	4,500 kg

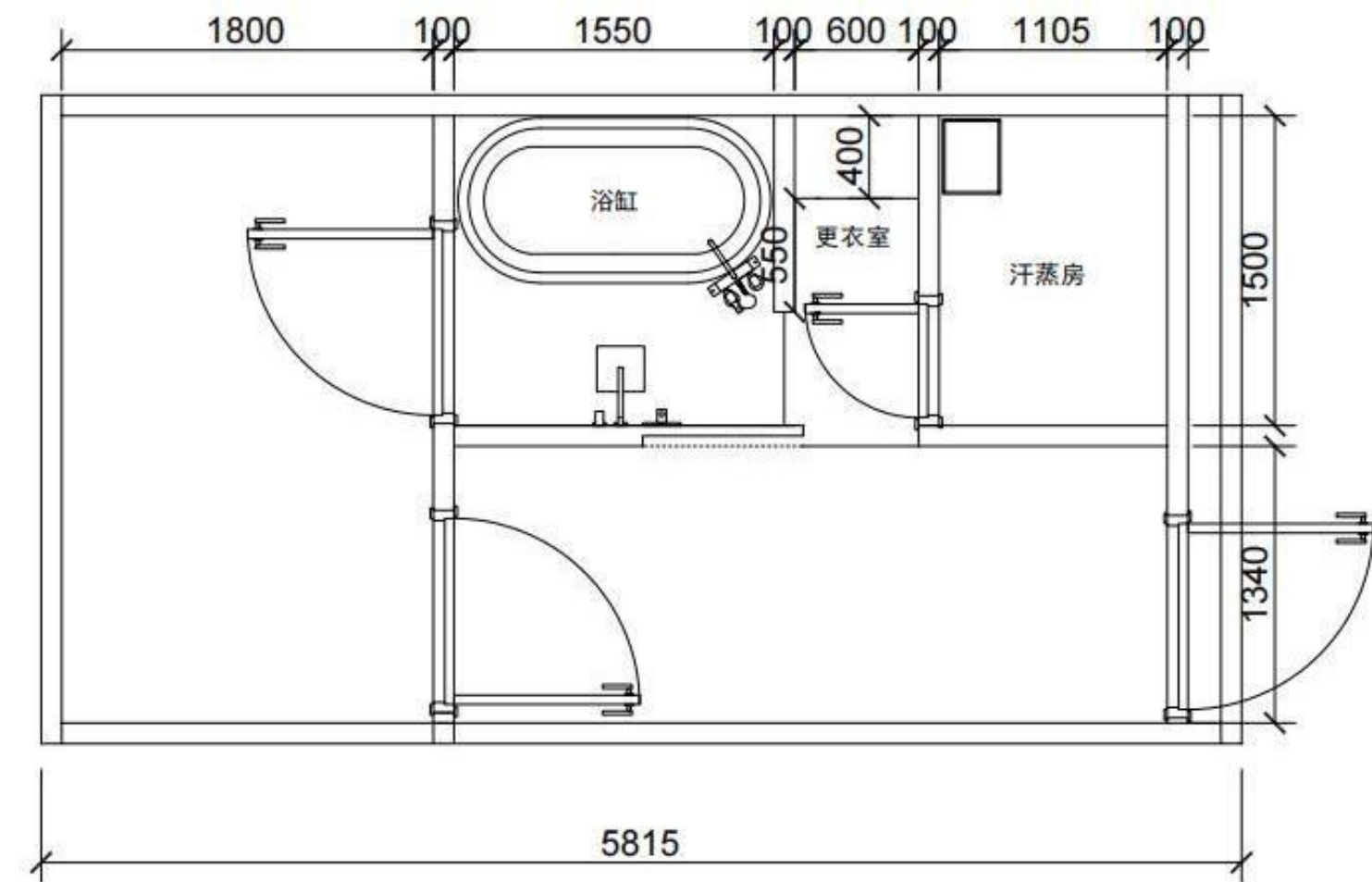



Jiangsu Flower
Intelligent
Technology

Customized Garbage Room



Our Project Cases



From Concept to Completion, Proven by Projects





PROFESSIONAL · RELIABLE · YOUR TRUSTED PARTNER

Contact Us for a Customized Quote

Contact person: Zhang Weifei

Contact: +8615061975169

Email :1031045900@qq.com